



Licensing and Regulatory Sub-Committee (Hearing)

Time and Date

10.00 am on Monday, 10th February, 2020

Place

Dame Ellen Terry Suite - Council House

Public Business

1. **Appointment of Chair**
2. **Apologies**
3. **Declarations of Interest**
4. **Licensing Act 2003 - Application to Vary a Premises Licence** (Pages 3 - 58)

To consider an application to vary a premises licence in respect of Buzz Bingo, Savoy Buildings, 268 Radford Road, Coventry, CV6 3BU

Note: The applicant and their representative have been invited to attend the hearing.

Persons who have made representations have been invited to attend.

The City Council's Statement of Licensing Policy is available on the Council's website. Alternatively, please contact us if you require a hard copy.

5. **Any Other Business**

To consider any other items of business which the Chair decides to take as a matter of urgency because of the special circumstances involved.

Private Business

Nil

Martin Yardley, Deputy Chief Executive (Place), Council House Coventry

30 January 2020

Note: The person to contact about the agenda and documents for this meeting is Usha Patel Tel: 024 7697 2301

Membership: Councillors J Birdi, B Gittins and C Thomas

Please note: a hearing loop is available in the committee rooms

If you require a British Sign Language interpreter for this meeting
OR if you would like this information in another format or
language please contact us.

Usha Patel/Carolyn Sinclair

Tel: 024 7683 3198/3166

**Email: usha.patel@coventry.gov.uk or
Carolyn.Sinclair@coventry.gov.uk**



Licensing & Regulatory Sub-Committee

23 January 2020

Name of Cabinet Member:

Not applicable

Director Approving Submission of the report:

Deputy Chief Executive (Place)

Ward(s) affected:

Radford

Title: Application to vary a Premises Licence under the Licensing Act 2003

Is this a key decision?

No

Executive Summary:

The purpose of this report is to consider an application to vary a Premises Licence under the Licensing Act 2003 for Buzz Bingo, Savoy Buildings, 268 Radford Road, Coventry, CV6 3BU.

Recommendations:

The Sub-Committee is recommended to consider whether to:

1. Grant the application as requested
2. Grant the application subject to such conditions that are necessary to promote the Licensing Objectives.
3. Refuse the application wholly or in part where it is necessary in order to promote the Licensing Objectives

List of Appendices included:

1. Premises Licence Variation application
2. Plan of Premises
3. Representation
4. Current Premises Licence
5. Location Plan
6. Hearing Procedure Note
7. Relevant Hearing Briefing Note

Background papers:

Section 182 Licensing Act 2003 Guidance

It is a statutory obligation of the Sub-Committee to take into account the Government's Guidance to the Licensing Act 2003 before reaching a decision.

Statement of Licensing Policy

The Council will have regard to the policy when making a decision on applications made under the Act.

Other Useful documents

None

Has it been or will it be considered by Scrutiny?

No

Has it been or will it be considered by any other Council Committee, Advisory Panel or other body?

No

Will this report go to Council?

No

Report title: Premises Variation Application

1. Context (or background)

- 1.1 The Licensing Act 2003 requires Coventry City Council, as the Licensing Authority, to carry out its various licensing functions so as to promote the following four Licensing Objectives:
- The Prevention of crime & disorder
 - The Protection of public safety
 - The Prevention of public nuisance
 - The Protection of children from harm
- 1.2 A Premises Licence Variation application for Buzz Bingo was received on 29 November 2019.
- 1.3 The application seeks to remove the restriction of opening hours. The Variation application also seeks to make changes to the internal layout of the premises including an extension of the slots area and a slight reconfiguration of the main seating area and diner (see Appendix 2). It should be noted that no changes to the licensable activities (hours) have been applied for.
- 1.4 One representation from a resident (other persons), has been received to the application (outlined in paragraph 3.3).
- 1.5 In addition to the mandatory conditions, the Sub-Committee should refer to the operating schedule detailed in the application (Appendix 1). No further conditions have been proposed with the application.
- 1.6 The Licensing Act 2003 requires the Council to publish a 'Statement of Licensing Policy' which sets out the policies the Council will have regard to and apply to promote the Licensing Objectives when making a decision on applications made under the Act. The Policy will be available at the hearing for reference purposes.
- 1.7 It is essential that the Sub-Committee takes into account the government's guidance to the Licensing Act before reaching a decision. The applicant, responsible authorities, or any other persons, should bring to the Sub-Committee's attention any relevant paragraphs. However, it is suggested good practice for Members of the Sub-Committee to read the relevant paragraph(s) of the guidance prior to the hearing.

2. Options considered and recommended proposal

- 2.1 There are three courses of action available to the Sub-Committee in relation to this application:
- (i) Grant the application as requested. If the Sub-Committee consider that granting the application would not undermine any of the Licensing Objectives, it should be granted in full as submitted. This would be granted subject to mandatory conditions and conditions consistent with the applicant's operating schedule, and any other conditions agreed by the applicant as part of the consultation / mediation process. Any conditions to be attached to a licence must be appropriate to promote the Licensing Objectives.
 - (ii) Grant the application as above, but the Sub-Committee could impose extra conditions as it thinks fit, or make amendments to the operating schedule conditions, and/or proposed hours. This option may include adding any conditions suggested by other

parties at the hearing, including the applicant. Any conditions to be attached to a licence must be appropriate to promote the Licensing Objectives.

(iii) If the Sub-Committee concludes that no additional conditions would ensure that the Licensing Objectives would be upheld, then the whole application should be rejected.

2.2 Your officer recommends option (ii).

The reason for this recommendation is that there have been no representations made by the responsible authorities. The concerns outlined in the representation (other persons) can be reduced by adding conditions to the Premises Licence. Appropriate conditions can be considered after the mediation meeting has taken place. If problems do occur, then the Review procedure is available to both responsible authorities and other persons.

2.3 The Sub-Committee are advised that they may depart from the officer recommendation if, having heard all the evidence, they believe it is appropriate to do so. Should the Sub-Committee decide to depart from the recommendation and choose an alternative option, they must provide full reasons for this decision, based on the promotion of the Licensing Objectives. This application should be considered on its own merits and all the circumstances considered before a decision is made.

2.4 The Sub-Committee must also be aware that licences can be reviewed at any time by any Responsible Authority or any 'other person', if it is considered that any of the Licensing Objectives have been undermined following the grant of the Premises Licence.

3. Results of consultation undertaken

3.1 As prescribed by the Licensing Act 2003, the application has been out for consultation to statutory consultees (Responsible Authorities) and any other persons for 28 days in the form of a notice displayed on the premises, and a notice published in a local newspaper.

3.2 Responsible Authorities have received a copy of the application. Please see below responses received:

Responsible Authority	Response Received	Objections	Conditions Agreed
Licensing	No	-	-
Police	Yes	No	-
Environmental Protection	Yes	No	-
Fire Safety	No	-	-
Health & Safety	No	-	-
Trading Standards	Yes	No	-
Planning	No	-	-
Safeguarding Children	No	-	-
Public Health	No	-	-
Secretary of State	No	-	-

3.3 One representation has been received from a resident (any other persons). The grounds for the representation is that the granting of the extension to the hours as requested would undermine the Licensing Objective of Prevention of Public Nuisance. The representations note concerns regarding litter from smoking and drinking alcohol at the front of the premises, parking issues and noise emanating from the premises during the evenings. There are concerns that no restriction on the hours would cause an increase in public nuisance.

3.4 The objector has accepted an offer of attending a mediation meeting to see if any resolution can be reached (date to be confirmed).

4. Timetable for implementing this decision

- 4.1 The Appeal period is 21 days beginning on the date that the Appellant(s) receive notification of the decision of the Licensing Authority.

5. Comments from Director of Finance and Resources

5.1 Financial implications

There are no financial implications arising directly from this report. However, there are possible cost implications if an appeal against the decision is made to the Magistrates Court and the decision of the Sub-Committee is not upheld.

5.2 Legal implications

The Licensing Act 2003 sets out how applications for variations to premises licences should be dealt with where valid representations have been submitted. The Sub-Committee have to decide the outcome of the application taking into account the four Licensing Objectives.

In accordance with the provisions of the Act, if a Licensing Authority rejects in whole or in part, an application to grant a variation, the applicant may appeal against the decision, to a Magistrates' court within 21 days of receiving notification of the decision.

Similarly, where a person who made relevant representations in relation to the application contends that the licence ought not to have been granted or that alternative or additional conditions should have been imposed on the licence, they may appeal against the decision, to a Magistrates' court within 21 days of receiving notification of the decision.

6. Other implications

6.1 How will this contribute to achievement of the Council's key objectives / corporate priorities (corporate plan/scorecard) / organisational blueprint or Coventry Sustainable Community Strategy

It is the Regulatory Services team's responsibility to ensure that members of the public in Coventry are not put at risk. This contributes to the Council's core aim of ensuring that citizens live longer healthier lives. The business' failure to uphold the Licensing Objectives may have an adverse effect on Public Safety and citizen's quality of life.

6.2 How is risk being managed?

If the application is not handled in line with the Licensing Act 2003, there is a risk of judicial appeals, reviews and associated costs.

6.3 What is the impact on the organisation?

None

6.4 Equalities / EIA

This decision will not affect the service provision and therefore details of the Equalities Impact Assessment are not relevant in this case.

6.5 Implications for (or impact on) climate change and the environment

None

6.6 Implications for partner organisations?

The Council recognises that the licensing function is only one means of promoting delivery of the above objectives and should not therefore be seen as a means for solving all problems within the community. The Council will therefore continue to work with the West

Midlands Police, Community Safety Partnership, local people and those involved in child protection (Coventry Safeguarding Children Board) to promote the common objectives as outlined.

6.7 Human Rights Act Implications

None

Report author(s):

Name and job title:

Rekha Masih, Lead Licensing Officer

Directorate: Place

Telephone: 024 7697 2247

Email: rekha.masih@coventry.gov.uk

Enquiries should be directed to the above person.

Contributor/approver name	Title	Directorate or organisation	Date doc sent out	Date response received or approved
Contributors:				
Carolyn Sinclair/Usha Patel	Governance Services Officer	Place	06/01/2020	06/01/2020
Davina Blackburn	Regulatory Services Manager	Place	06/01/2020	07/01/2020
Tracy Miller	Strategic Lead Planning & Regulation	Place	06/01/2020	08/01/2020
Names of approvers for submission: (officers and members)				
Amy Wright	Solicitor	Place	06/01/2020	06/01/2020
Andrew Walster	Director (Streetscene & Regulatory Services)	Place	07/01/2020	07/01/2020
Cath Crosby	Lead Accountant	Place	06/01/2020	06/01/2020

This report is published on the Council's website:

www.coventry.gov.uk/councilmeetings

Application to vary a premises licence under the Licensing Act 2003

PLEASE READ THE FOLLOWING INSTRUCTIONS FIRST

Before completing this form please read the guidance notes at the end of the form. If you are completing this form by hand please write legibly in block capitals. In all cases ensure that your answers are inside the boxes and written in black ink. Use additional sheets if necessary.

You may wish to keep a copy of the completed form for your records.

I/We Buzz Group Limited

(Insert name(s) of applicant)

being the premises licence holder, apply to vary a premises licence under section 34 of the Licensing Act 2003 for the premises described in Part 1 below

Premises licence number LN/215000343
--

Part 1 – Premises Details

Postal address of premises or, if none, ordnance survey map reference or description Buzz Bingo Savoy Buildings 268 Radford Road			
Post town	Coventry	Postcode	CV6 3BU

Telephone number at premises (if any)	
Non-domestic rateable value of premises	£143,000

Part 2 – Applicant details

Daytime contact telephone number			
E-mail address (optional)			
Current postal address if different from premises address	Buzz Group Limited New Castle House Castle Boulevard		
Post town	Nottingham	Postcode	NG7 1FT

Part 3 - Variation

Please tick as appropriate

Do you want the proposed variation to have effect as soon as possible?

Yes

No

If not, from what date do you want the variation to take effect?

DD	MM	YYYY

Do you want the proposed variation to have effect in relation to the introduction of the late night levy? (Please see guidance note 1) Yes No

Please describe briefly the nature of the proposed variation (Please see guidance note 2)

This application is for approval to remove restriction of opening hours and for approval of amended premises licence plans to reflect alterations to the areas designated as licensed for the provision of licensable activities including; an extension of the slots area and a slight reconfiguration of the main seating area and diner.

If your proposed variation would mean that 5,000 or more people are expected to attend the premises at any one time, please state the number expected to attend:

Part 4 Operating Schedule

Please complete those parts of the Operating Schedule below which would be subject to change if this application to vary is successful.

- | Provision of regulated entertainment (Please see guidance note 3) | Please tick all that apply |
|---|-----------------------------------|
| a) plays (if ticking yes, fill in box A) | <input type="checkbox"/> |
| b) films (if ticking yes, fill in box B) | <input type="checkbox"/> |
| c) indoor sporting events (if ticking yes, fill in box C) | <input type="checkbox"/> |
| d) boxing or wrestling entertainment (if ticking yes, fill in box D) | <input type="checkbox"/> |
| e) live music (if ticking yes, fill in box E) | <input type="checkbox"/> |
| f) recorded music (if ticking yes, fill in box F) | <input type="checkbox"/> |
| g) performances of dance (if ticking yes, fill in box G) | <input type="checkbox"/> |
| h) anything of a similar description to that falling within (e), (f) or (g) (if ticking yes, fill in box H) | <input type="checkbox"/> |

Provision of late night refreshment (if ticking yes, fill in box I)

Supply of alcohol (if ticking yes, fill in box J)

In all cases complete boxes K, L and M

A

Plays Standard days and timings (please read guidance note 8)			Will the performance of a play take place <u>indoors or outdoors or both – please tick</u> (please read guidance note 4)	Indoors	<input type="checkbox"/>
				Outdoors	<input type="checkbox"/>
Day	Start	Finish		Both	<input type="checkbox"/>
Mon			<u>Please give further details here</u> (please read guidance note 5)		
Tue			<u>State any seasonal variations for performing plays</u> (please read guidance note 6)		
Wed			<u>Non standard timings. Where you intend to use the premises for the performance of plays at different times to those listed in the column on the left, please list</u> (please read guidance note 7)		
Thur					
Fri					
Sat					
Sun					

B

Films Standard days and timings (please read guidance note 8)			<u>Will the exhibition of films take place indoors or outdoors or both – please tick (please read guidance note 4)</u>	Indoors	<input type="checkbox"/>
				Outdoors	<input type="checkbox"/>
				Both	<input type="checkbox"/>
Day	Start	Finish			
Mon			<u>Please give further details here (please read guidance note 5)</u>		
Tue					
Wed			<u>State any seasonal variations for the exhibition of films (please read guidance note 6)</u>		
Thur					
Fri			<u>Non standard timings. Where you intend to use the premises for the exhibition of films at different times to those listed in the column on the left, please list (please read guidance note 7)</u>		
Sat					
Sun					

C

Indoor sporting events Standard days and timings (please read guidance note 8)			<u>Please give further details</u> (please read guidance note 5)
Day	Start	Finish	
Mon			<u>State any seasonal variations for indoor sporting events</u> (please read guidance note 6)
Tue			<u>Non standard timings. Where you intend to use the premises for indoor sporting events at different times to those listed in the column on the left, please list</u> (please read guidance note 7)
Wed			
Thur			
Fri			
Sat			
Sun			

D

Boxing or wrestling entertainments Standard days and timings (please read guidance note 8)			<u>Will the boxing or wrestling entertainment take place indoors or outdoors or both – please tick</u> (please read guidance note 4)	Indoors	<input type="checkbox"/>
				Outdoors	<input type="checkbox"/>
				Both	<input type="checkbox"/>
Day	Start	Finish			
Mon			<u>Please give further details here</u> (please read guidance note 5)		
Tue					
Wed			<u>State any seasonal variations for boxing or wrestling entertainment</u> (please read guidance note 6)		
Thur					
Fri			<u>Non standard timings. Where you intend to use the premises for boxing or wrestling entertainment at different times to those listed in the column on the left, please list</u> (please read guidance note 7)		
Sat					
Sun					

E

Live music Standard days and timings (please read guidance note 8)			Will the performance of live music take place indoors or outdoors or both – please tick (please read guidance note 4)	Indoors	<input type="checkbox"/>
				Outdoors	<input type="checkbox"/>
				Both	<input type="checkbox"/>
Day	Start	Finish			
Mon			<u>Please give further details here</u> (please read guidance note 5)		
Tue					
Wed			<u>State any seasonal variations for the performance of live music</u> (please read guidance note 6)		
Thur					
Fri			<u>Non standard timings. Where you intend to use the premises for the performance of live music at different times to those listed in the column on the left, please list</u> (please read guidance note 7)		
Sat					
Sun					

F

Recorded music Standard days and timings (please read guidance note 8)			Will the playing of recorded music take place indoors or outdoors or both – please tick (please read guidance note 4)	Indoors	<input type="checkbox"/>
				Outdoors	<input type="checkbox"/>
				Both	<input type="checkbox"/>
Day	Start	Finish			
Mon			<u>Please give further details here (please read guidance note 5)</u>		
Tue					
Wed			<u>State any seasonal variations for the playing of recorded music (please read guidance note 6)</u>		
Thur					
Fri			<u>Non standard timings. Where you intend to use the premises for the playing of recorded music at different times to those listed in the column on the left, please list (please read guidance note 7)</u>		
Sat					
Sun					

G

Performances of dance Standard days and timings (please read guidance note 8)			<u>Will the performance of dance take place indoors or outdoors or both – please tick</u> (please read guidance note 4)	Indoors	<input checked="" type="checkbox"/>
Day	Start	Finish		Outdoors	<input type="checkbox"/>
Mon			<u>Please give further details here</u> (please read guidance note 5)	Both	<input type="checkbox"/>
Tue					
Wed			<u>State any seasonal variations for the performance of dance</u> (please read guidance note 6)		
Thur					
Fri			<u>Non standard timings. Where you intend to use the premises for the performance of dance at different times to those listed in the column on the left, please list</u> (please read guidance note 7)		
Sat					
Sun					

H

Anything of a similar description to that falling within (e), (f) or (g) Standard days and timings (please read guidance note 8)			Please give a description of the type of entertainment you will be providing		
Day	Start	Finish	<u>Will this entertainment take place indoors or outdoors or both – please tick</u> (please read guidance note 4)	Indoors	<input type="checkbox"/>
Mon				Outdoors	<input type="checkbox"/>
				Both	<input type="checkbox"/>
Tue			<u>Please give further details here</u> (please read guidance note 5)		
Wed					
Thur			<u>State any seasonal variations for entertainment of a similar description to that falling within (e), (f) or (g)</u> (please read guidance note 6)		
Fri					
Sat			<u>Non standard timings. Where you intend to use the premises for the entertainment of a similar description to that falling within (e), (f) or (g) at different times to those listed in the column on the left, please list</u> (please read guidance note 7)		
Sun					

I

Late night refreshment Standard days and timings (please read guidance note 8)			Will the provision of late night refreshment take place indoors or outdoors or both – please tick (please read guidance note 4)	Indoors	<input type="checkbox"/>
Day	Start	Finish		Outdoors	<input type="checkbox"/>
Mon			Please give further details here (please read guidance note 5)	Both	<input type="checkbox"/>
Tue					
Wed			State any seasonal variations for the provision of late night refreshment (please read guidance note 6)		
Thur					
Fri			Non standard timings. Where you intend to use the premises for the provision of late night refreshment at different times, to those listed in the column on the left, please list (please read guidance note 7)		
Sat					
Sun					

J

Supply of alcohol Standard days and timings (please read guidance note 8)			Will the supply of alcohol be for consumption – please tick (please read guidance note 9)	On the premises	<input type="checkbox"/>
				Off the premises	<input type="checkbox"/>
				Both	<input type="checkbox"/>
Day	Start	Finish	<u>State any seasonal variations for the supply of alcohol</u> (please read guidance note 6) <u>Non-standard timings. Where you intend to use the premises for the supply of alcohol at different times to those listed in the column on the left, please list</u> (please read guidance note 7)		
Mon					
Tue					
Wed					
Thur					
Fri					
Sat					
Sun					

K

Please highlight any adult entertainment or services, activities, other entertainment or matters ancillary to the use of the premises that may give rise to concern in respect of children (please read guidance note 10).

The premises operates as a bingo club with the provision of gambling facilities including slot machines.

L

Hours premises are open to the public Standard days and timings (please read guidance note 8)			<u>State any seasonal variations</u> (please read guidance note 6)
Day	Start	Finish	
Mon	00:00	23:59	
Tue	00:00	23:59	
Wed	00:00	23:59	
Thur	00:00	23:59	
Fri	00:00	23:59	
Sat	00:00	23:59	
Sun	00:00	23:59	
			<u>Non standard timings. Where you intend the premises to be open to the public at different times from those listed in the column on the left, please list</u> (please read guidance note 7)

Please identify those conditions currently imposed on the licence which you believe could be removed as a consequence of the proposed variation you are seeking.

N/A

Please tick as appropriate

- I have enclosed the premises licence
- I have enclosed the relevant part of the premises licence

If you have not ticked one of these boxes, please fill in reasons for not including the licence or part of it below

Reasons why I have not enclosed the premises licence or relevant part of premises licence.
N/A

M Describe any additional steps you intend to take to promote the four licensing objectives as a result of the proposed variation:

a) General – all four licensing objectives (b, c, d and e) (please read guidance note 11)

1) This application is for approval of structural changes and for removal of opening hours to permit the provision of slots under the Gambling Act 2005 and accordingly all existing licence conditions are capable for upholding the licensing objectives.

b) The prevention of crime and disorder

See above

c) Public safety

See above

d) The prevention of public nuisance

See above

e) The protection of children from harm

See above

Checklist:

Please tick to indicate agreement

- I have made or enclosed payment of the fee; or
- I have not made or enclosed payment of the fee because this application has been made in relation to the introduction of the late night levy.
- I have sent copies of this application and the plan to responsible authorities and others where applicable.
- I understand that I must now advertise my application.
- I have enclosed the premises licence or relevant part of it or explanation.
- I understand that if I do not comply with the above requirements my application will be rejected.

IT IS AN OFFENCE, UNDER SECTION 158 OF THE LICENSING ACT 2003, TO MAKE A FALSE STATEMENT IN OR IN CONNECTION WITH THIS APPLICATION. THOSE WHO MAKE A FALSE STATEMENT MAY BE LIABLE ON SUMMARY CONVICTION TO A FINE OF ANY AMOUNT.

Part 5 – Signatures (please read guidance note 12)

Signature of applicant (the current premises licence holder) or applicant’s solicitor or other duly authorised agent (please read guidance note 13). **If signing on behalf of the applicant, please state in what capacity.**

Signature	<i>Eversheds Sutherland (International) LLP</i>
Date	<i>28/11/19</i>
Capacity	<i>Duly Authorised Agents.</i>

Where the premises licence is jointly held, signature of 2nd applicant (the current premises licence holder) or 2nd applicant’s solicitor or other authorised agent (please read guidance note 14). **If signing on behalf of the applicant, please state in what capacity.**

Signature	
Date	
Capacity	

Contact name (where not previously given) and address for correspondence associated with this application (please read guidance note 15)			
Amy Worthington Eversheds Sutherland (International) LLP Eversheds House 70 Great Bridgewater Street #9125566			
Post town	Manchester	Post code	M1 5ES
Telephone number (if any)	0161 831 8009		

If you would prefer us to correspond with you by e-mail, your e-mail address (optional)
Davidnroberts@eversheds-sutherland.com

Notes for Guidance

This application cannot be used to vary the licence so as to extend the period for which the licence has effect or to vary substantially the premises to which it relates. If you wish to make that type of change to the premises licence, you should make a new premises licence application under section 17 of the Licensing Act 2003.

1. You do not have to pay a fee if the only purpose of the variation for which you are applying is to avoid becoming liable for the late night levy
2. Describe the premises. For example, the type of premises, its general situation and layout and any other information which could be relevant to the licensing objectives. Where your application includes off-supplies of alcohol and you intend to provide a place of consumption of these off-supplies of alcohol, you must include a description of where the place will be and its proximity to the premises.
3. In terms of specific regulated entertainments please note that:
 - Plays: no licence is required for performances between 08.00 and 23.00 on any day, provided that the audience does not exceed 500.
 - Films: no licence is required for 'not-for-profit' film exhibition held in community premises between 08.00 and 23.00 on any day provided that the audience does not exceed 500 and the organiser (a) gets consent to the screening from a person who is responsible for the premises; and (b) ensures that each such screening abides by age classification ratings.
 - Indoor sporting events: no licence is required for performances between 08.00 and 23.00 on any day, provided that the audience does not exceed 1000.
 - Boxing or Wrestling Entertainment: no licence is required for a contest, exhibition or display of Greco-Roman wrestling, or freestyle wrestling between 08.00 and 23.00 on any day, provided that the audience does not exceed 1000. Combined fighting sports – defined as a contest, exhibition or display which combines boxing or wrestling with one or more martial arts – are licensable as a boxing or wrestling entertainment rather than an indoor sporting event.
 - Live music: no licence permission is required for:
 - a performance of unamplified live music between 08.00 and 23.00 on any day, on any premises.
 - a performance of amplified live music between 08.00 and 23.00 on any day on premises authorised to sell alcohol for consumption on those premises, provided that the audience does not exceed 500.
 - a performance of amplified live music between 08.00 and 23.00 on any day, in a workplace that is not licensed to sell alcohol on those premises, provided that the audience does not exceed 500.
 - a performance of amplified live music between 08.00 and 23.00 on any day, in a church hall, village hall, community hall, or other similar community premises, that is not licensed by a premises licence to sell alcohol, provided that (a) the audience does not exceed 500, and (b) the organiser gets consent for the performance from a person who is responsible for the premises.
 - a performance of amplified live music between 08.00 and 23.00 on any day, at the non-residential premises of (i) a local authority, or (ii) a school, or (iii) a hospital, provided that (a) the audience does not exceed 500, and (b) the organiser gets consent for the performance on the relevant premises from: (i) the local authority concerned, or (ii) the school or (iii) the health care provider for the hospital.

- Recorded Music: no licence permission is required for:
 - any playing of recorded music between 08.00 and 23.00 on any day on premises authorised to sell alcohol for consumption on those premises, provided that the audience does not exceed 500.
 - any playing of recorded music between 08.00 and 23.00 on any day, in a church hall, village hall, community hall, or other similar community premises, that is not licensed by a premises licence to sell alcohol, provided that (a) the audience does not exceed 500, and (b) the organiser gets consent for the performance from a person who is responsible for the premises.
 - any playing of recorded music between 08.00 and 23.00 on any day, at the non-residential premises of (i) a local authority, or (ii) a school, or (iii) a hospital, provided that (a) the audience does not exceed 500, and (b) the organiser gets consent for the performance on the relevant premises from: (i) the local authority concerned, or (ii) the school proprietor or (iii) the health care provider for the hospital.
 - Dance: no licence is required for performances between 08.00 and 23.00 on any day, provided that the audience does not exceed 500. However, a performance which amounts to adult entertainment remains licensable.
 - Cross activity exemptions: no licence is required between 08.00 and 23.00 on any day, with no limit on audience size for:
 - any entertainment taking place on the premises of the local authority where the entertainment is provided by or on behalf of the local authority;
 - any entertainment taking place on the hospital premises of the health care provider where the entertainment is provided by or on behalf of the health care provider;
 - any entertainment taking place on the premises of the school where the entertainment is provided by or on behalf of the school proprietor; and
 - any entertainment (excluding films and a boxing or wrestling entertainment) taking place at a travelling circus, provided that (a) it takes place within a moveable structure that accommodates the audience, and (b) that the travelling circus has not been located on the same site for more than 28 consecutive days.
4. Where taking place in a building or other structure please tick as appropriate (indoors may include a tent).
 5. For example state type of activity to be authorised, if not already stated, and give relevant further details, for example (but not exclusively) whether or not music will be amplified or unamplified.
 6. For example (but not exclusively), where the activity will occur on additional days during the summer months.
 7. For example (but not exclusively), where you wish the activity to go on longer on a particular day e.g. Christmas Eve.
 8. Please give timings in 24 hour clock (e.g. 16.00) and only give details for the days of the week when you intend the premises to be used for the activity.
 9. If you wish people to be able to consume alcohol on the premises, please tick 'on the premises'. If you wish people to be able to purchase alcohol to consume away from the premises, please tick 'off the premises'. If you wish people to be able to do both, please tick 'both'.
 10. Please give information about anything intended to occur at the premises or ancillary to the use of the premises which may give rise to concern in respect of children regardless of whether you intend children to have access to the premises, for example (but not exclusively) nudity or semi-nudity, films for restricted age groups or the presence of gaming machines.
 11. Please list here steps you will take to promote all four licensing objectives together.

12. The application form must be signed.
13. An applicant's agent (for example solicitor) may sign the form on their behalf provided that they have actual authority to do so.
14. Where there is more than one applicant, each of the applicants or their respective agents must sign the application form.
15. This is the address which we shall use to correspond with you about this application.

This page is intentionally left blank

THIS DRAWING IS THE PROPERTY OF GALA LEISURE LTD. ALL DIMENSIONS TO BE CHECKED ON SITE PRIOR TO COMMENCEMENT OF ANY WORK OR MANUFACTURE. THIS DRAWING SHOULD BE READ IN CONJUNCTION WITH THE SPECIFICATION OF WORKS WHERE THIS IS RELEVANT.

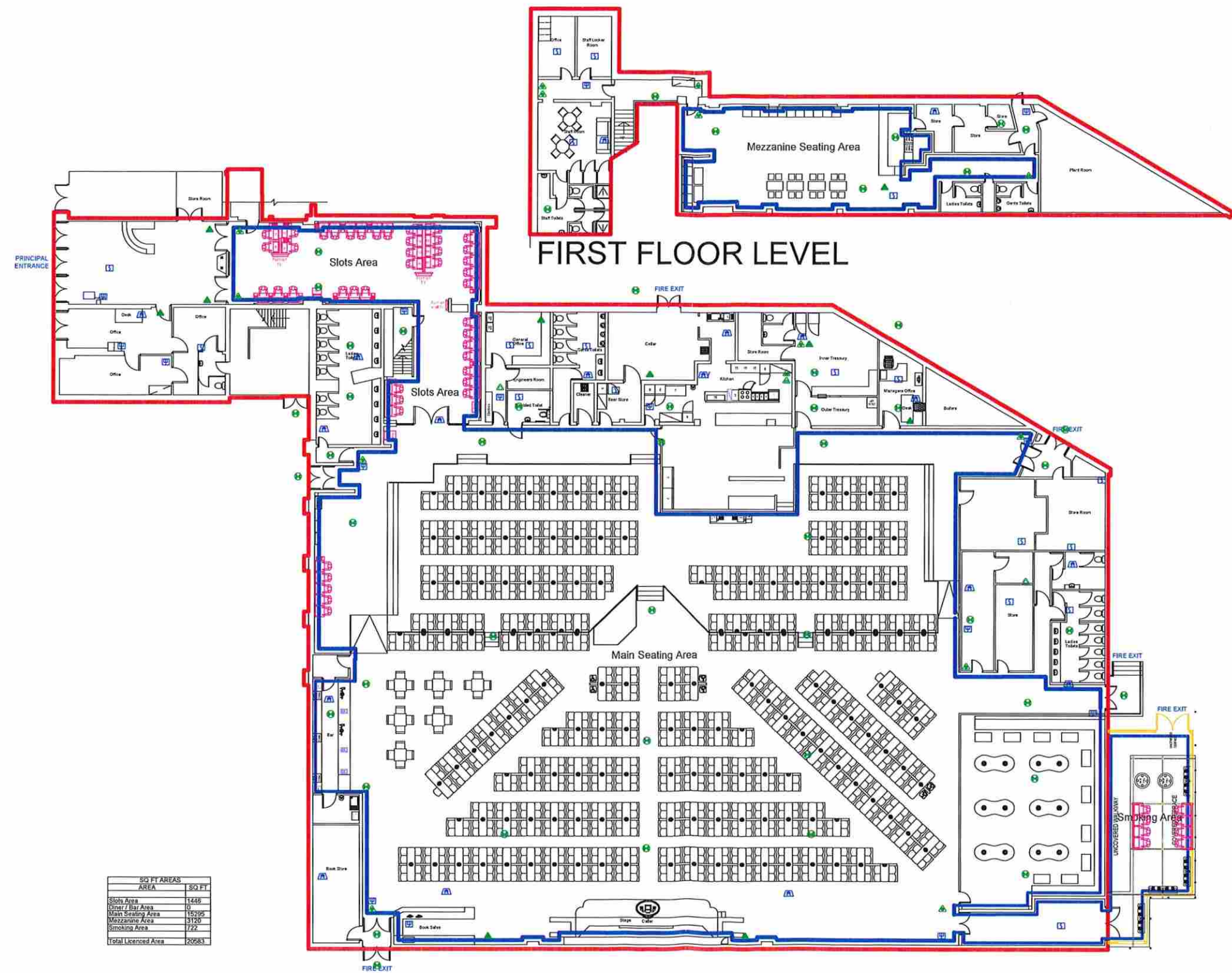

SQ FT AREAS	AREA	SQ FT
Slots Area	1446	
Inner / Bar Area	0	
Main Seating Area	15795	
Mezzanine Area	3100	
Smoking Area	772	
Total Licenced Area	20913	

PORTABLE FIRE FIGHTING EQUIPMENT	INITIATING EQUIPMENT
▲ FIRE EXTINGUISHER, WATER TYPE	☐ HEAT DETECTOR
▲ FIRE EXTINGUISHER, FOAM TYPE	☐ SMOKE DETECTOR
▲ FIRE EXTINGUISHER, POWDER TYPE	☐ FLAME DETECTOR
▲ FIRE EXTINGUISHER, WET POWDER TYPE	☐ GAS DETECTOR
▲ FIRE EXTINGUISHER, ABC POWDER TYPE	☐ MANUAL CALL POINT
▲ FIRE EXTINGUISHER, GAS TYPE	☐ ATTACHED TO ANY SYMBOL, INDICATES THAT IT IS LOCATED OUTSIDE THE ROOM
▲ FIRE EXTINGUISHER, W/ION GAS TYPE	
▲ FIRE EXTINGUISHER, GRABON DRAGGE TYPE	
▲ FIRE EXTINGUISHER, RET CHEMICAL TYPE	
▲ FIRE EXTINGUISHER, HYDRANT TYPE	
▲ WATER BUCKET	
▲ SAND BUCKET	
▲ FIRE BLANKET	
	WARNING EQUIPMENT
	☐ WARNING DEVICE, MANUAL SOUNDER
	☐ WARNING DEVICE, BELL
	☐ WARNING DEVICE, LOUDSPEAKER
	☐ WARNING DEVICE, TELEPHONE
	☐ WARNING DEVICE, VISUAL

FIXED FIRE FIGHTING EQUIPMENT	FIRE DOOR RATING
▲ FIRE SYSTEM, WATER	☐ 15 MIN FIRE DOOR (SELF CLOSING)
▲ FIRE SYSTEM, FOAM	☐ 1 HOUR FIRE DOOR (SELF CLOSING)
▲ FIRE SYSTEM, POWDER	☐ 1 HOUR FIRE DOOR
▲ FIRE SYSTEM, GAS	☐ 1 HOUR FIRE DOOR
▲ FIRE SYSTEM, RET CHEMICAL	☐ FIRE DOOR NON RATED
	☐ FLOOR IS EXPOSED FROM ROOM ADJACENT
	LEGEND
	☐ ALL SYMBOLS TAKEN FROM BS 1551:1991

- ☐ EXTENT OF PREMISES
- ☐ SALE OF ALCOHOL, PROVISION OF LATE NIGHT REFRESHMENTS AND PROVISION OF REGULATED ENTERTAINMENT

REV	REVISION / ISSUE	DATE

CLIENT
 GALA LEISURE LTD
 PROPERTY DEPARTMENT
 NEW CASTLE HOUSE
 CASTLE BOULEVARD
 NOTTINGHAM
 NG7 1FT

PROJECT
 GALA BINGO COVENTRY SAVOY
 SAVOY BUILDINGS
 RADFORD ROAD
 COVENTRY
 CV6 3BU

TITLE
 PREMISES LICENCE

DRAWN BY: JOHN FAREY
DATE: MAY 2017
SCALE: 1:150 @ A1
DRAWING NUMBER: COVENTRY SAVOY - PREMISES LICENCE - MAY 17



GROUND FLOOR LEVEL

FIRST FLOOR LEVEL

This page is intentionally left blank

Coventry City Council
PO Box 15
Council House
Coventry
CV1 5RR

23 December 2019

Dear Sir/Madam

Buzz Bingo, Savoy Buildings, 268 Radford Road, Coventry, CV6 3BU

Application to vary terms under the Licensing Act 2003

We would like to draw attention to the following matters that form specific concerns in relation to the application to alter the terms of the gambling licence for the above premises.

1. Smoking

There is insufficient provision for a smoking area by the club to keep staff and patrons away from neighbouring premises. This creates a smoking nuisance to us, with their staff and patrons smoking in close proximity to us. This has led to smoking litter, which we then have to repeatedly clear from the front of our premises. There is also an accumulation of smoke fumes which is not welcome.

The staff and patrons also use the awning in front of our premises and even our own doorstep to then smoke in either very good or bad weather. This should be policed, but Buzz Bingo staff can be uncooperative, particularly when the Club Manager is not on the premises.

The Club does not control their staff and patrons and create an unnecessary nuisance to us as neighbours of the above premises. If the opening hours are extended the extent of difficulty in the context of conduct of staff or visitors may well be extended.

2. Drinking

Patrons of the club use the front of our premises to consume alcohol, resulting in a litter nuisance to us, with beer cans and other drink litter, which we then have to clear from our premises on an ongoing basis. The patrons of the club often sit on our property's wall and continue drinking and smoking.

Such behaviour should be controlled by the Club to prevent this from occurring by keeping alcohol consumption on their licensed premises.

3. Parking

The club has 2 car parks that can be used by club staff, patrons and additional visitors to the Buzz Bingo.

However, such users often occupy our limited parking spaces in front of our premises during our store opening hours and beyond, thus restricting our ability to both trade; and enter and leave our premises during their operational hours, even outside their actual club sessions.

We have drawn the matter to the attention of the Club Manager and have noticed that when the Manager, Brian Round is on duty, staff are somewhat better behaved. When the manager is not on duty, staff members park immediately outside our premises, both occupying spaces that our customers and staff may wish to use. This happens on an ongoing basis and is likely to be made worse in the event of extended hours.

In the evenings, in particular, it is not even possible to park outside our premises. Not only is this inconvenient for our own to access our premises, but it also creates a potential problem for Emergency Vehicles from accessing the Buzz Bingo Premises.

To leave when the evening bingo sessions are on can in practice be very difficult; at times it can also be very difficult for a vehicle to pass through the area in front of our premises to exit safely onto the main Radford Road. If a family car cannot pass through safely, it is difficult to see how an ambulance or fire tender can access the buildings if needed.

We would kindly request the Council to find constructive solutions to ensure the license holder puts in place adequate measures to prevent a continuance and exacerbation of these issues.

We need the club to take stronger measures to ensure their staff, patrons and visitors use their specific car parks. We need for our customers and ourselves to be able to park by our shop for trade and emergency access purposes. We also need the Buzz Bingo, its patrons, staff and visitors to clean up after themselves, and to smoke and drink away from our premises.

We are also specifically concerned by the added noise levels from the club additional machines we understand the Club is proposing to place on their premises, in addition to the prospect of exacerbating the above mentioned issues. We would be grateful to ensure - if the Club is allowed to have such machines, they are retained more centrally within the Bingo's own premises with appropriate sound shielding to neighbouring properties.

We would be grateful if the Council can review and amend the terms of the license to reduce noise and nuisance to neighbours.

In summary, this requires the Buzz Bingo to ensure their staff, patrons and visitors:

- Use the Buzz Bingo car parks
- Respect the need for neighbouring business owners, their customers and visitors to use the spaces in front of their premises.
- Smoke in Buzz Bingo territory and not by neighbouring properties where the smoke affects the people residing there (and cumulatively).
- Know not to make a litter, smoking and noise nuisance to neighbouring persons. Perhaps the Bingo can ensure a provision of a litter bin by the exit doors and a member of staff can ensure clean up around the property so as not to present a nuisance to neighbours.
- Sound proofing to avoid noise and disturbance to neighbours.



LICENSING ACT 2003

Full Premises Licence

Buzz Bingo

Premises licence number	LN/215000343
--------------------------------	--------------

Part One – Premises Details

Postal address of premises, or if none, ordnance survey map reference or description Buzz Bingo Savoy Buildings 268 Radford Road	
Post town Coventry	Post code CV6 3BU
Telephone number	

Where the licence is time limited the dates N/A

The times the licence authorises the carrying out of Licensable Activities		
On & Off Sales	Capacity	
Supply of Alcohol	From	To
Sunday	12:00	00:00
Monday	10:00	00:00
Tuesday	10:00	00:00
Wednesday	10:00	00:00
Thursday	10:00	00:00
Friday	10:00	00:00
Saturday	10:00	00:00

Commencement of alcohol permitted hours on New Year's Eve to the commencement of alcohol permitted on New Year's Day.



LICENSING ACT 2003

Full Premises Licence

Indoors	Capacity	
Exhibiting Film Live Music Recorded Music Performances of Dance Other entertainment	From	To
Sunday	12:00	00:00
Monday	10:00	00:00
Tuesday	10:00	00:00
Wednesday	10:00	00:00
Thursday	10:00	00:00
Friday	10:00	00:00
Saturday	10:00	00:00
New Year's Eve to New Year's Days		

Indoors	Capacity	
Late Night Refreshment		
Sunday	23:00	00:00
Monday	23:00	00:00
Tuesday	23:00	00:00
Wednesday	23:00	00:00
Thursday	23:00	00:00
Friday	23:00	00:00
Saturday	23:00	00:00
New Year's Eve to commencement of permitted hours on New Year's Day		

Hours	Capacity	
Open to the Public	From	To
Sunday	12:00	00:00
Monday	10:00	00:00
Tuesday	10:00	00:00
Wednesday	10:00	00:00
Thursday	10:00	00:00
Friday	10:00	00:00
Saturday	10:00	00:00

LICENSING ACT 2003

Full Premises Licence

Where the licence authorises supplies of alcohol whether these are on and/or off supplies

ON & OFF SALES

Part Two

Name, (registered) address, telephone number(s) and email (where relevant) of holder of premises licence

Buzz Group Limited
New Castle House
Castle Boulevard
Nottingham
NG7 1FT

Registered number of holder, for example company number, charity number (where applicable)

00794943

Name, (registered) address, and telephone number(s) of designated premises supervisor where the premises licence authorises the supply of alcohol

Brian John Round
[REDACTED]

Personal Licence Number and Issuing Authority of Personal Licence held by Designated Premises Supervisor where the premises authorises the supply of alcohol

Licence number - 1093 - Birmingham City Council



LICENSING ACT 2003

Full Premises Licence

Dated this 21st May 2019



Regulatory Services Manager

Regulatory Services
Licensing Team

Streetscene & Regulatory Services
PO Box 15
Coventry City Council
Earl Street
Coventry
CV1 5RR

Annex 1

Mandatory Conditions

Section 19 Licensing Act 2003

Where this licence authorises the supply of alcohol,

- 1. No supply of alcohol may be made under the licence:**
 - a. at a time when there is no designated premises supervisor (DPS) in respect of the licence, or**
 - b. at a time when the DPS does not hold a personal licence or that licence is suspended**

- 2. Every supply of alcohol under the licence must be made or authorised by a person who holds a personal licence**

Section 20 Licensing Act 2003

Where this licence authorises the exhibition of films,

- (1) the admission of children to the exhibition of any film will be restricted.**
- (2) Where the film classification body is specified in the licence, unless otherwise stated, admission of children must be restricted in accordance with any recommendation made by that body.**
- (3) Where :**
 - i. the film classification body is not specified in the licence, or**
 - ii. the licensing authority has notified the holder of the licence that this subsection applies to the film in question, admission of children must be restricted in accordance with any recommendation made by that licensing authority.**

Section 21 Licensing Act 2003

Where this licence includes a condition that at specified times one or more individuals must be on the premises to carry out a security activity, each such individual must be licensed by the Security Industry Authority.

The Licensing Act 2003 (Mandatory Licensing Conditions) Order 2014

Where a licence authorises alcohol to be consumed on the premises the following conditions apply:

1. (1) The responsible person must ensure that staff on relevant premises do not carry out, arrange or participate in any irresponsible promotions in relation to the premises.

(2) In this paragraph, an irresponsible promotion means any one or more of the following activities, or substantially similar activities, carried on for the purpose of encouraging the sale or supply of alcohol for consumption on the premises—

(a) games or other activities which require or encourage, or are designed to require or encourage, individuals to—

(i) drink a quantity of alcohol within a time limit (other than to drink alcohol sold or supplied on the premises before the cessation of the period in which the responsible person is authorised to sell or supply alcohol), or

(ii) drink as much alcohol as possible (whether within a time limit or otherwise);

(b) provision of unlimited or unspecified quantities of alcohol free or for a fixed or discounted fee to the public or to a group defined by a particular characteristic in a manner which carries a significant risk of undermining a licensing objective;

(c) provision of free or discounted alcohol or any other thing as a prize to encourage or reward the purchase and consumption of alcohol over a period of 24 hours or less in a manner which carries a significant risk of undermining a licensing objective;

(d) selling or supplying alcohol in association with promotional posters or flyers on, or in the vicinity of, the premises which can reasonably be considered to condone, encourage or glamorise anti-social behaviour or to refer to the effects of drunkenness in any favourable manner;

(e) dispensing alcohol directly by one person into the mouth of another (other than where that other person is unable to drink without assistance by reason of disability).

2. The responsible person must ensure that free potable water is provided on request to customers where it is reasonably available.

3. (1) The premises licence holder or club premises certificate holder must ensure that an age verification policy is adopted in respect of the premises in relation to the sale or supply of alcohol.

(2) The designated premises supervisor in relation to the premises licence must ensure that the supply of alcohol at the premises is carried on in accordance with the age verification policy.

(3) The policy must require individuals who appear to the responsible person to be under 18 years of age (or such older age as may be specified in the policy) to produce on request, before being served alcohol, identification bearing their photograph, date of birth and either—

(a) a holographic mark, or

(b) an ultraviolet feature.

4. The responsible person must ensure that—

(a) where any of the following alcoholic drinks is sold or supplied for consumption on the premises (other than alcoholic drinks sold or supplied having been made up in advance ready for sale or supply in a securely closed container) it is available to customers in the following measures—

(i) beer or cider: ½ pint;

(ii) gin, rum, vodka or whisky: 25 ml or 35 ml; and

(iii) still wine in a glass: 125 ml;

(b) these measures are displayed in a menu, price list or other printed material which is available to customers on the premises; and

(c) where a customer does not in relation to a sale of alcohol specify the quantity of alcohol to be sold, the customer is made aware that these measures are available.”

Licensing Act 2003 (Mandatory Licensing Conditions) Order 2014

A relevant person shall ensure that no alcohol is sold or supplied for consumption on or off the premises for a price which is less than the permitted price.

For the purposes of the condition set out in paragraph 1—

(a) “duty” is to be construed in accordance with the Alcoholic Liquor Duties Act 1979;

(b) “permitted price” is the price found by applying the formula—

$$P = D + (D \times V)$$

Conditions consistent with the Operating Schedule

Licensees Statement of Operating Schedule as attached including:

Part 1

- A) General all four licensing objectives
- B) The Prevention of Crime and Disorder
- C) Public Safety
- D) Prevention of Public Nuisance
- E) Protection of Children from Harm

Part 2

Conditions reproducing the effect of all conditions currently attached to the existing licence (both standard and special conditions).

Licensing Act 1964- None

Theatres Act 1968- None

Cinemas Act 1985 - None

Local Government (Miscellaneous Provisions) Act, 1982 – None

P Describe the steps you intend to take to promote the four licensing objectives:

Premises Name – Buzz Bingo

a) General – all four licensing objectives (b,c,d,e) (please read guidance note 9)

No additional steps intended. All licensable activities are presently lawfully provided at current permitted times and variation to terminal hours sought will not give rise to any additional risks in view of the strict controls already in place (including those required by the Gaming Board for Great Britain) in relation to:- (i) Management and supervision of the premises (ii) Conduct of customers and staff. The other variations sought do not give rise to additional risks. The Premises Licence will be subject to the mandatory conditions set out in Section 19 Licensing Act 2003

b) The prevention of crime and disorder

c) Public safety

d) The prevention of public nuisance

e) The protection of children from harm

Persons under 18 are not permitted to the premises

Annex 3

Conditions Attached after a Hearing by the Licensing Authority

None

Annex 4

Plans

The Plan attached to this licence as attached.

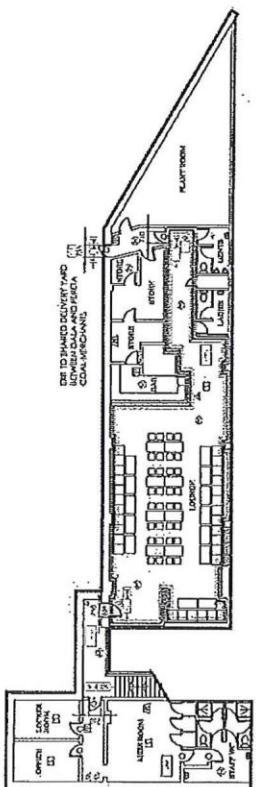

FIRST FLOOR LEVEL

- LEGEND**
- PORTABLE FIRE FIGHTING EQUIPMENT**
- 1. Fire extinguisher
 - 2. Fire hose
 - 3. Fire blanket
 - 4. Fire extinguisher (portable)
 - 5. Fire extinguisher (portable)
 - 6. Fire extinguisher (portable)
 - 7. Fire extinguisher (portable)
 - 8. Fire extinguisher (portable)
 - 9. Fire extinguisher (portable)
 - 10. Fire extinguisher (portable)
- FIXED FIRE FIGHTING EQUIPMENT**
- 1. Fire alarm pull station
 - 2. Fire alarm pull station
 - 3. Fire alarm pull station
 - 4. Fire alarm pull station
 - 5. Fire alarm pull station
 - 6. Fire alarm pull station
 - 7. Fire alarm pull station
 - 8. Fire alarm pull station
 - 9. Fire alarm pull station
 - 10. Fire alarm pull station
- OTHER**
- 1. Fire alarm pull station
 - 2. Fire alarm pull station
 - 3. Fire alarm pull station
 - 4. Fire alarm pull station
 - 5. Fire alarm pull station
 - 6. Fire alarm pull station
 - 7. Fire alarm pull station
 - 8. Fire alarm pull station
 - 9. Fire alarm pull station
 - 10. Fire alarm pull station

- STATUS OF FEATURES**
- 1. As of 1/1/2010
 - 2. As of 1/1/2010
 - 3. As of 1/1/2010
 - 4. As of 1/1/2010
 - 5. As of 1/1/2010
 - 6. As of 1/1/2010
 - 7. As of 1/1/2010
 - 8. As of 1/1/2010
 - 9. As of 1/1/2010
 - 10. As of 1/1/2010

ITEM	QTY	UNIT	VALUE
STAIRS	1	EA	1000
ELEVATORS	1	EA	1000
MECHANICAL	1	EA	1000
PLUMBING	1	EA	1000
ELECTRICAL	1	EA	1000
MECHANICAL	1	EA	1000
PLUMBING	1	EA	1000
ELECTRICAL	1	EA	1000
TOTAL			6000

GALA CORAL GROUP

GENERAL NOTES

CONSTRUCTION SHALL BE IN ACCORDANCE WITH THE LATEST EDITIONS OF THE BUILDING CODES AND SPECIFICATIONS OF THE STATE OF FLORIDA.

ALL WORK SHALL BE SUBJECT TO THE APPROVAL OF THE ARCHITECT AND THE ENGINEER OF RECORD.

THE CONTRACTOR SHALL BE RESPONSIBLE FOR OBTAINING ALL NECESSARY PERMITS AND APPROVALS FROM THE APPROPRIATE AGENCIES.

ALL MATERIALS AND WORKMANSHIP SHALL BE SUBJECT TO INSPECTION AND APPROVAL BY THE ARCHITECT AND THE ENGINEER OF RECORD.

THE CONTRACTOR SHALL MAINTAIN ACCESS TO ALL ADJACENT PROPERTIES AT ALL TIMES.

ALL UTILITIES SHALL BE PROTECTED AND MAINTAINED AT ALL TIMES.

ALL WORK SHALL BE COMPLETED WITHIN THE SPECIFIED TIME FRAME.

ALL COSTS SHALL BE SUBJECT TO THE APPROVAL OF THE ARCHITECT AND THE ENGINEER OF RECORD.

ALL DISPUTES SHALL BE REFERRED TO MEDIATION AND THEN TO ARBITRATION.

ALL RIGHTS ARE RESERVED BY THE ARCHITECT AND THE ENGINEER OF RECORD.

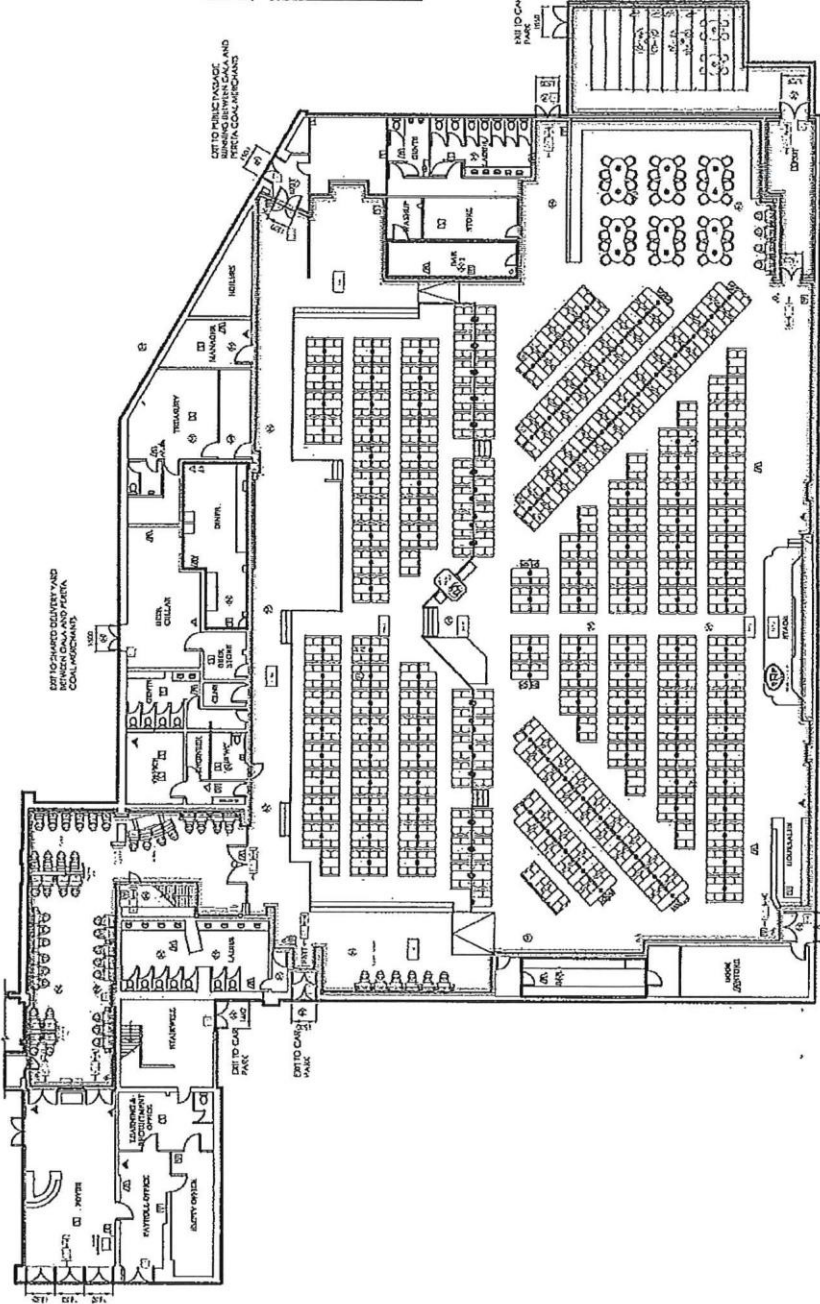

GROUND FLOOR LEVEL

LICENSING ACT 2003

Summary Licence To Be Displayed

Buzz Bingo

Premises licence number	LN/215000343
--------------------------------	--------------

Postal address of premises, or if none, ordnance survey map reference or description	
Buzz Bingo Savoy Buildings 268 Radford Road	
Post town	Post code
Coventry	CV6 3BU
Telephone number	

Where the licence is time limited the dates
N/A

The times the licence authorises the carrying out of licensable activities		
On & Off Sales	Capacity	
Supply of Alcohol	From	To
Sunday	12:00	00:00
Monday	10:00	00:00
Tuesday	10:00	00:00
Wednesday	10:00	00:00
Thursday	10:00	00:00
Friday	10:00	00:00
Saturday	10:00	00:00

Commencement of alcohol permitted hours on New Year's Eve to the commencement of alcohol permitted on New Year's Day.



LICENSING ACT 2003

Summary Licence

To Be Displayed

Indoors		Capacity
Exhibiting Film	From	To
Live Music		
Recorded Music		
Performances of Dance		
Other entertainment		
Sunday	12:00	00:00
Monday	10:00	00:00
Tuesday	10:00	00:00
Wednesday	10:00	00:00
Thursday	10:00	00:00
Friday	10:00	00:00
Saturday	10:00	00:00
New Year's Eve to New Year's Days		

Indoors		Capacity
Late Night Refreshment		
Sunday	23:00	00:00
Monday	23:00	00:00
Tuesday	23:00	00:00
Wednesday	23:00	00:00
Thursday	23:00	00:00
Friday	23:00	00:00
Saturday	23:00	00:00
New Year's Eve to commencement of permitted hours on New Year's Day		

Hours		Capacity
Open to the Public	From	To
Sunday	12:00	00:00
Monday	10:00	00:00
Tuesday	10:00	00:00
Wednesday	10:00	00:00
Thursday	10:00	00:00
Friday	10:00	00:00
Saturday	10:00	00:00

Where the licence authorises supplies of alcohol whether these are on and/or off supplies

ON & OFF SALES



LICENSING ACT 2003

Summary Licence

To Be Displayed

Name, (registered) address, telephone number(s) and email (where relevant) of holder of premises licence

Buzz Group Limited
New Castle House
Castle Boulevard
Nottingham
NG7 1FT

Registered number of holder, for example company number, charity number (where applicable)

00794943

Name of Designated Premises Supervisor where the Premises Licence authorises the supply of alcohol

Brian John Round

State whether access to the premises by children is restricted or prohibited

RESTRICTED

Dated this 21st May 2019

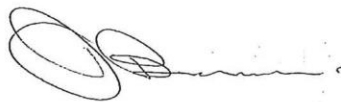

Regulatory Services Manager

Regulatory Services
Licensing Team

Streetscene & Regulatory Services
PO Box 15
Coventry City Council
Earl Street
Coventry
CV1 5RR



This page is intentionally left blank

This Map is reproduced from the Ordnance Survey mapping with the permission of the controller of Her Majesty's Stationery Office © Crown Copyright. Unauthorised reproduction infringes Crown Copyright and may lead to prosecution or civil proceedings.

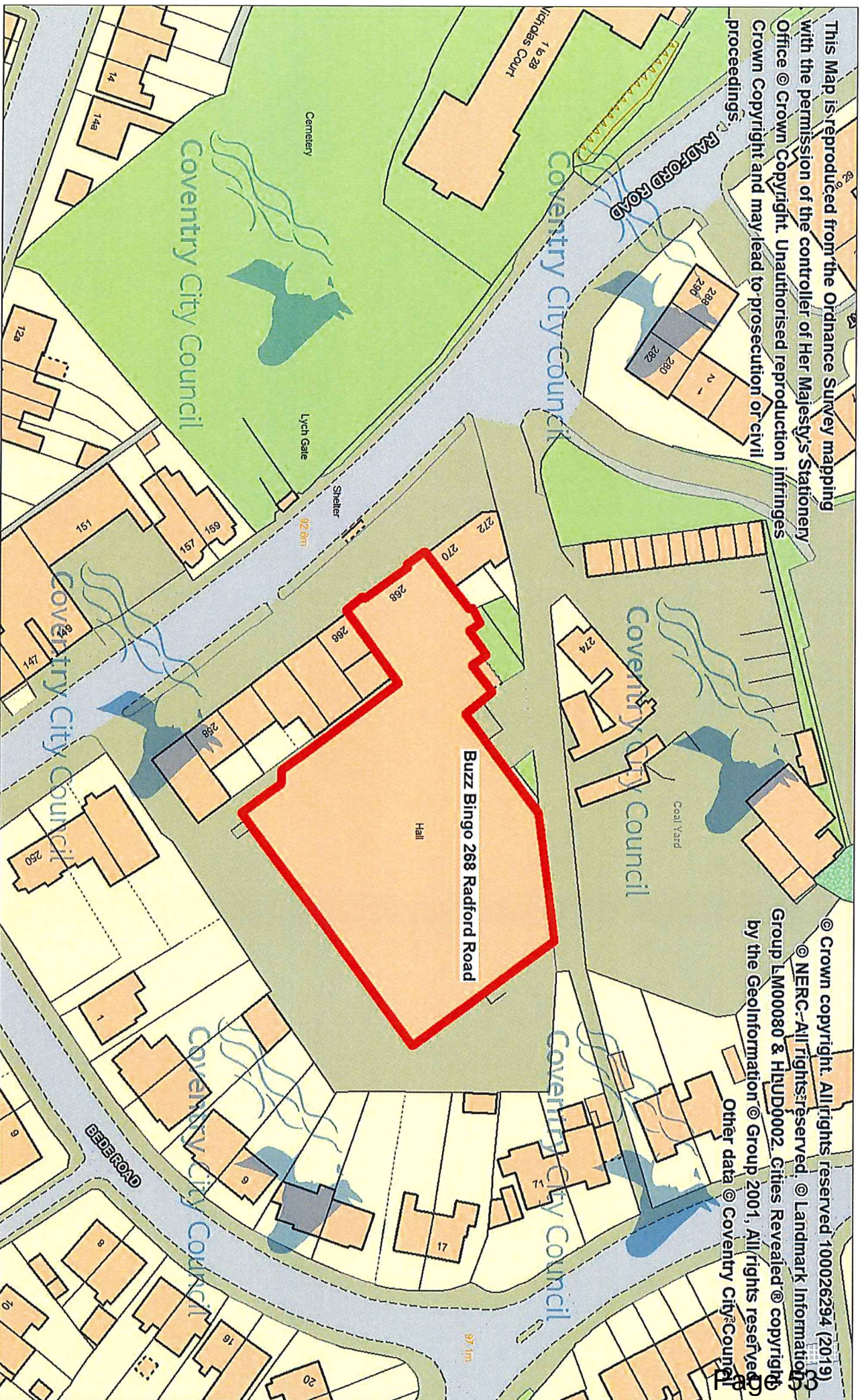

© Crown copyright. All rights reserved 100026294 (2019)
 © NERC - All rights reserved. © Landmark Information Group L/M00080 & H/UD0002. Cities Revealed © copyright by the GeoInformation © Group 2001. All rights reserved. Other data © Coventry City Council

Environmental Protection
 Coventry City Council
 One Friargate
 Coventry CV1 2GN



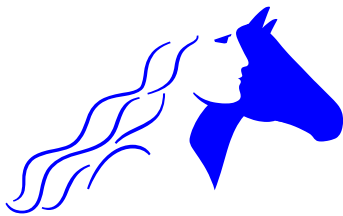

Coventry City Council

LICENSING ACT 2003

LICENSING SUB-COMMITTEE

HEARING PROCEDURE NOTE

1. The Members of the Sub-committee will enter the hearing room.
2. The Chair will introduce the Members of the Sub-committee and its supporting officers (normally a legal adviser and a minute taker) and will ask each of the parties (and their representatives) to identify themselves.
3. The Chair will ask if the parties have received and understood the procedure note (and in particular that cross-examination by the parties is not allowed) and whether anyone present would like the procedure explained further?
4. The Chair will confirm any relevant further documents the licensing authority has received before the hearing and will be considering, and will ask the parties whether there are any other documents they now wish to present (subject to the other parties' consent) and their reasons for doing so.
5. The Chair will ask if any party wishes to call witnesses in support of their case and their reasons for doing so.
6. The Licensing Officer will give a brief description of the application, confirm whether all relevant application formalities have been complied with and where relevant, that the authority has notified the parties of any points that the authority wanted clarification on at the hearing?
7. The Chair will invite the applicant/licensee/review applicant (or representative) to present their case (maximum 20 minutes).
8. The Chair will invite Members of the Sub-committee to ask the applicant/licensee/review applicant (or representative) questions.
9. The Chair will invite each objector/review review respondent (or representative) to present their case (maximum 20 minutes each)
10. The Chair will invite Members of the Sub-committee to ask each objector/review respondent (or representative) questions.
11. The Chair will invite each objector/review respondent (or representative) to sum up their case and if they wish, to comment on anything said by any other party (maximum 10 minutes).
12. The Chair will invite the applicant/licensee/review applicant to sum up their case and if they wish, to comment on anything said by any other party (maximum 10 minutes).

- *[13. The Members of the Sub-committee will retire with their supporting officers to make their decision.
- 14 The Members of the Sub-committee and their supporting officers will return to the hearing room and the Chair will invite the Committee Solicitor to inform the meeting of the decision made, any facts relied on, the reasons for the decision and any specific legal advice given.
15. The Sub-committee's decision will be confirmed in a written Notice of Determination that will be issued to all parties within 10 working days of the determination.
- * Where permitted by the Act, the Chair may close the meeting at this point and re-convene the meeting in private at a later date for the Sub-committee to make its decision.

Licensing Act 2003

Briefing Note 3 – Hearing to Consider a Premises Licence Variation Application

Background

The holder of a premises licence can apply to vary the terms of that licence. A variation application cannot be used to extend the life of a time-limited premises licence or to substantially alter the premises covered by the licence. A new premises licence application would be required to achieve this involving a fresh "Operating Schedule" and plan.

A hearing is required because "relevant representations" (i.e. relevant to the licensing objectives) have been made by a "responsible authority" (i.e. police, fire or local government agencies) or any other person or both.

Section 182 Guidance (Apr 2018)

Particular reference should be made to Parts 8.66f, 9 and 10.

Local Statement of Licensing Policy (2016)

Particular reference should be made to Parts 4, 5, 6, 7

Human Rights Act

The hearing procedure and the availability of a statutory right of appeal comply with the Article 6 requirement to provide a fair hearing when determining the applicant's and objectors' civil rights. A decision to vary a licence will only be regarded as infringing the Article 8 rights of local residents/businesses if any noise/disturbance likely to be caused is of an extreme nature. Given the police powers to close premises in these circumstances this is unlikely to be an issue at application stage.

The Sub-committee's powers

Having heard from the applicant and the other parties the sub-committee may:

- (a) grant the application; or
- (b) grant the application in part or with additional or modified conditions; or
- (c) reject the application outright

Different conditions can be made to apply to different areas of the premises or to different licensable activities taking place on the premises.

Rights of Appeal

An aggrieved applicant can appeal to Coventry Magistrates' Court against any decision made by the sub-committee that falls within (b) and (c) above. An aggrieved objector can also appeal against the grant of an application (i.e. (a) and (b) above).

Monitoring/Enforcement

If an application is approved, monitoring and enforcement of Premises Licence conditions will be carried out in accordance with the Licensing Enforcement Policy.